

4550 Series

Bottom Roll Framed Aluminum Sliding Door System

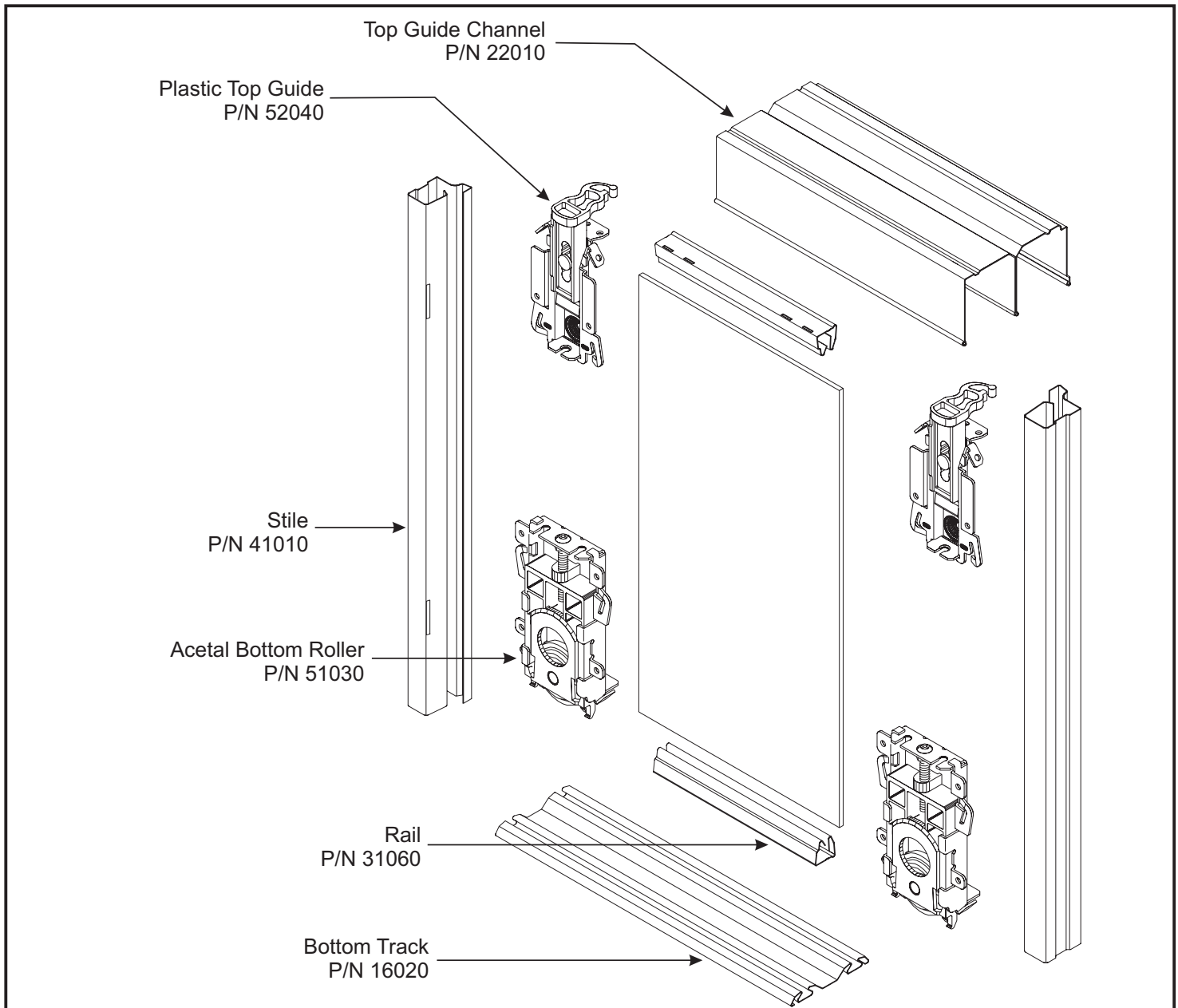

INSTALLATION QUESTIONS OR MISSING PARTS? DO NOT RETURN THIS DOOR TO THE STORE!

Thank you for purchasing this Slimfold product. We take pride in the products we manufacture and are confident you will be pleased with your selection. However, sometimes a product may leave our factory in less than perfect condition. If you have questions or are missing component parts necessary to complete the installation, **do not return the door to the place of purchase.** Give us a call first. More than likely, we can solve the problem without the hassle and expense of returning the door to the store.
Call Customer Service: 1-800-633-7553 from 8:00 a.m. to 5:00 p.m. CST, Monday through Friday.



P.O. BOX 6416 | DOTHAN, ALABAMA 36302-6416
800-633-7553
 334-793-3462 (fax)
www.dunbarton.com
 email: slimfold@dunbarton.com

BEFORE YOU BEGIN

PLEASE FOLLOW ALL INSTRUCTIONS AND ALWAYS USE PROTECTIVE EYEWEAR WHEN INSTALLING A DOOR SYSTEM. PLEASE READ INSTRUCTIONS COMPLETELY.

Assemble Tools

Safety Glasses Level
Phillips head screwdriver Tape Measure
Straight edge screwdriver Power drill or screw gun (3/16" bit)

Measure Opening

Measure the Finished Opening Size; refer to Specifications below to insure proper door size.

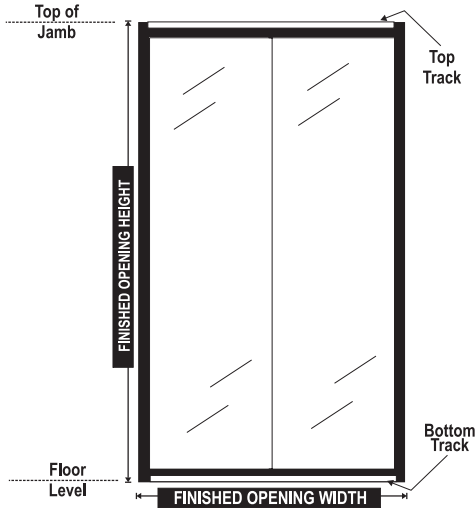

MIRROR: 3mm float plate glass mirror, safety backed to conform with Uniform Building Code Standard 23-2, Part II. Safety mirror 400 lb. ft. Impact test ANSI Z-97.1 1984 boil and impact test. 4mm float plate glass mirror for heights greater than 7'0."

Specifications

STANDARD SIZES—TWO PANEL UNITS

Size	Door Width	FINISHED OPENING WIDTH	FIN. OPNG HEIGHTS	
			6'8" Units	8'0" Units
4'0" (1219)	24-5/8" (626)	48" (1219)	80-1/2" (2045)	96" (2438)
5'0" (1524)	30-5/8" (778)	60" (1524)	+1"/-3" (+2.54/-7.62)	
6'0" (1829)	36-5/8" (930)	72" (1829)		
8'0" (2438)	48-5/8" (1235)	96" (2438)		

STANDARD SIZES—THREE PANEL UNITS

Size	Door Width	FINISHED OPENING WIDTH	FIN. OPNG HEIGHTS	
			6'8" Units	8'0" Units
9'0" (2743)	36-5/8" (930)	108" (2743)	80-1/2" (2045)	96" (2438)
12'0" (3658)	48-5/8" (1235)	144" (3658)		

Finished Opening Width Tolerance +1/2"/-2" (+12.7/-50.8)

All increments shown in (parenthesis) are metric (millimeter) unless otherwise indicated. Non-standard sizes available; check with your dealer for sizes and availability.

INSTALLATION

1. Trim Track to Fit Opening

Using a fine tooth hacksaw, cut the Top Guide Channel and Bottom Track 1/16" (2mm) shorter than the opening width. Insert 2x4 (51x102mm) wood blocks into channel for support.

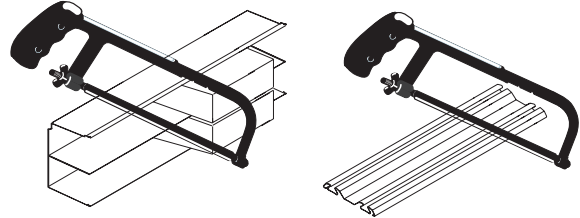

2. Attach Top Guide Channel

Screw Top Guide Channel into the header of your opening locating the front edge 1/16" (2mm) back from the jamb face as shown. Avoid using excessive force when screwing into header as this could deform the Top Guide

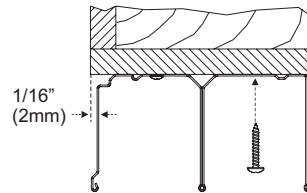

3. Attach Bottom Track

Locate the leading edge of the floor track 7/8" (22mm) back from the front face of the jamb so doors will hang plumb.

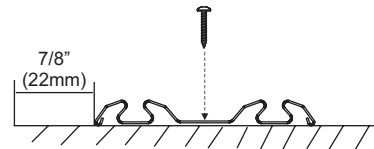

Note:

For installation over carpet it is recommended to cut the carpet and shim the track with wood strips.

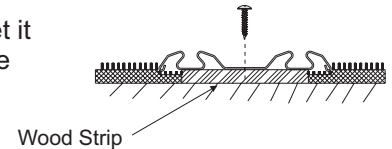

4. Install Doors

Tilt the door as shown, and insert the top guides into the rear channel. Insert the bottom rollers into the rear groove of the bottom track. To prevent scratching, place two pieces of wood or cardboard over the bottom track. Repeat with the second door, using the front channel and groove.

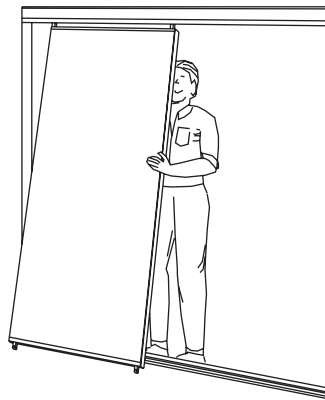

5. Adjust Doors

For vertical adjustment of each door use a star screwdriver on the bottom rollers as shown.

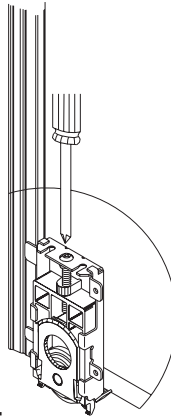

Cross-Sectional Layout of Installed Doors

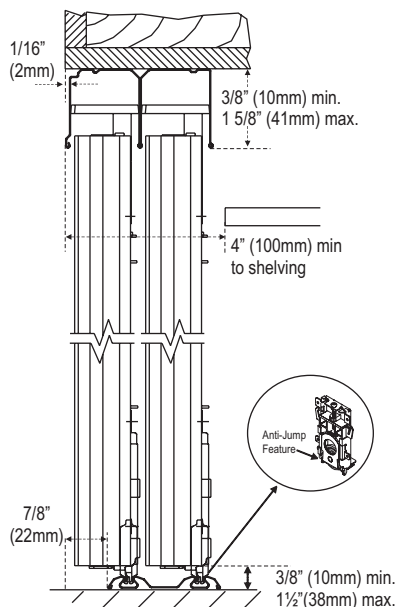

Mirror Dimensions:

Mirror Width =

Opening width + 1" (25mm) per overlap] / [# of doors]

Mirror Length =

Opening height - 2 5/8" (67mm)

Mirror Thickness =

Heights up to 7'0" - 3mm

Heights over 7'0" - 4mm

Note: All mirror must be used with safety backing conforming to local building code standards. Safety backing must reach the mirror edges. Mirror edges should be polished to prevent crack propagation after cutting.

SLIMFOLD PRODUCTS LIMITED LIFETIME WARRANTY

Slimfold Products Division warrants to the purchaser that its products, when utilized for interior door use, will be free from defects in materials and workmanship for the life of the product. Slimfold Products manufactured with galvanized steel are additionally warranted against rusting for a period of one (1) year from the date of purchase, provided the finish has not been cut or abraded through the metal. Galvanized steel should be used where air has a high salt content or in locations with high humidity.

This warranty is applicable only when the products covered by it have been installed in accordance with the recommended written installation instructions of Slimfold Products Division and with established building practices, have been accorded treatment which is considered good practice in the building industry regarding storage and maintenance, and have been subjected only to normal use. Because Slimfold Products Division cannot control the manner in which its products are handled after leaving its premises, this warranty does not apply to the finish or other damage occurring during shipment.

There are no warranties, express or implied, which extend beyond the description on the face hereof, including the implied warranty of merchantability and the implied warranty of fitness for a particular purpose.

Some states do not allow limitations on how long an implied warranty lasts, so the above limitation may not apply in some cases.

In the event the original consumer purchaser of any Slimfold product believes that the door or any parts thereof covered by this warranty is defective, a letter outlining the alleged defect should be sent postage prepaid to the following address:

**Slimfold Products Division
PO Box 6416
Dothan, AL 36302**

Any Slimfold Products part covered by this warranty which, upon inspection by an authorized representative of Slimfold Products Division, are found by said representative to be defective, will be repaired or replaced at the option of Slimfold Products Division. The purchase price of the part will be refunded and does not include labor, installation costs, finishing costs, or indirect or consequential damages of any nature. Some states do not allow the exclusion or limitation of incidental or consequential damages, so the above limitation or exclusion may not apply to you.

This warranty bestows certain legal rights, and you may also have other rights which vary from state to state.

CARING FOR YOUR SLIMFOLD DOOR

KEEP TRACK FREE OF DIRT AND PAINT!

Steel Bifolds

Clean steel surface with a soft cloth using a mild detergent and water. Do not use harsh cleaners or abrasive.

Mirrors

- Clean mirror surface with clean, warm water or approved glass cleaner. Do not use any acid or alkali cleaners or cleaners with ammonia base. They will attack front surface, edges and backing of glass.
- Use a clean, soft cloth when cleaning to avoid scratching mirror surface.
- Never spray any cleaner directly on to the mirror. Apply to cloth first, then wipe mirror.
- Be sure to dry all edges thoroughly.



Closet Systems

P.O. BOX 6416 | DOTHAN, ALABAMA 36302-6416
800-633-7553
334-793-3462 (fax)
www.dunbarton.com
email: slimfold@dunbarton.com